

BID SPECIFICATIONS

STANDARD

- * MATCHES 24H DISPLAY LINE AND COUNTERS
- * STAINLESS STEEL WORK SURFACE
- * 8" STAINLESS STEEL CYLINDER WITH COVERS
- * ADDITIONAL CYLINDER STORAGE
- * FORCED AIR COOLING SYSTEM
- * TEMPERATURE CONTROL. STANDARD ON ALL CASES
- * REMOTE APPLICATION
- * CHASSIS CONSTRUCTION MADE OF ANODIZED ALUMINUM
- * INSULATED WITH DENSE NON-CFC ECOLOGIC POLYURETHANE FOAM
- * INSIDE STRUCTURE MADE OF HIGH GLOSS 304 STAINLESS STEEL

- * SHIPPED FULLY ASSEMBLED
- * THE STANDARD LIMITED WARRANTY INCLUDES:
1 YEAR PARTS; 90 DAYS LABOR
- * CASE(S) TO BE LABORATORY CERTIFIED AS DESCRIBED

OPTIONAL

- * WATER COOLED CONDENSING UNIT
- * OPTIONAL TOP SHELF

- * SIDE & FRONT PANELS PAINTED IN RAL FINISH

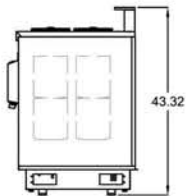

24h La Rossa Pozzetti Ice Cream Dipping Cabinet (Remote) Technical Specifications

Model no.	Case Heights	Case Lengths (Option #1)	Case Depth (Option #1)	Case Lengths (Option #2)	Case Depth (Option #2)	Crated Weights (lb)	Remote Condensing Unit	Working Temp F	8" Rounds Capacity
BPG A07	37.80"	29.52"	29.42"	31.02"	33.42"	446	220/1/60	-10 to + 10	4
BPG A10	37.80"	39.36"	29.42"	40.86"	33.42"	490	220/1/60	-10 to + 10	6
BPG A12	37.80"	49.20"	29.42"	50.70"	33.42"	534	220/1/60	-10 to + 10	8
BPG A15	37.80"	59.05"	29.42"	60.55"	33.42"	578	220/1/60	-10 to + 10	10
BPG A20	37.80"	68.88"	29.42"	70.38"	33.42"	578	220/1/60	-10 to + 10	12

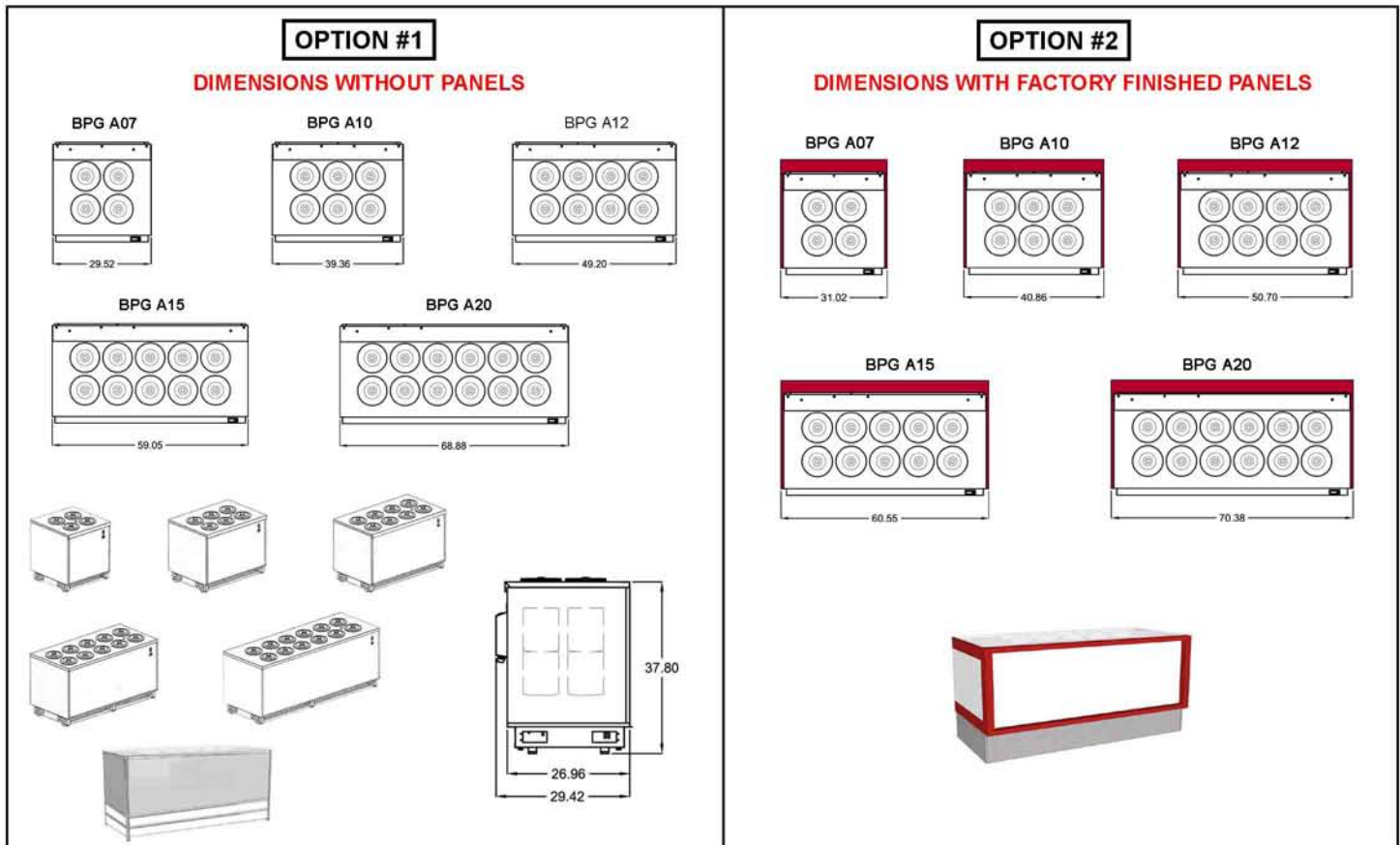

LISTINGS:



ELECTRICAL CONNECTION:

Display cases are shipped with applicable junction box for hardwired installation
Options exist for several NEMA configurations
Plug and/or receptacle configurations are at the discretion of the electrical installer

NOTE:

Required ambient conditions: 75°F; 55% RH
Drawing and Specifications are subject to change without notice

CLABO USA INC.
2556 Barrington Court,
Hayward, CA 94545 USA
PH 800.672.2784
FAX 510.441.0401
<http://www.otl-america.com>